

Laspuntstuk / Kegelstutzen / Liners

DIN 11851



DN	D1	D2	D3	L	Art. Nr.	
					304	316L
DN 10	10.0	13.00	22.50	17	114000101	114000103
DN 15	16.0	19.00	28.50	17	114000151	114000153
DN 20	20.0	23.00	36.50	18	114000201	114000203
DN 25	26.0	29.00	44.00	22	114000251	114000253
DN 32	32.0	35.00	50.00	25	114000321	114000323
DN 40	38.0	41.00	56.00	26	114000401	114000403
DN 50	50.0	53.00	68.50	28	114000501	114000503
DN 65	66.0	70.00	86.00	32	114000651	114000653
DN 80	81.0	85.00	100.00	37	114000801	114000803
DN 100	100.0	104.00	121.00	44	114001001	114001003
DN 125	125.0	129.00	150.00	34	114001251	114001253
DN 150	150.0	154.00	176.00	37	114001501	114001503
DN 200	200.0	204.00	226.00	39	114002001	114002003

Inch/Zoll

Inch/Zoll	D1	D2	D3	L	Art. Nr.	
					304	316L
1.00"	22.1	25.4	44.00	22	114011001	114011003
1.50"	34.8	38.1	56.00	26	114011121	114011123
2.00"	47.5	50.8	68.50	28	114012001	114012003
2.50"	60.2	63.5	86.50	32	114012121	114012123
3.00"	72.9	76.1	93.00	32	114013001	114013003
4.00"	97.4	101.6	121.00	44	114014001	114014003
1.25"	28.8	31.80	50.00	22	114011141	114011143

Iso

ISO	D1	D2	D3	L	Art. Nr.	
					304	316L
DN 10 ISO	14.20	17.20	22.50	17	114080101	114080103
DN 15 ISO	18.10	21.30	28.50	17	114080151	114080153
DN 20 ISO	23.70	26.90	36.50	18	114080201	114080203
DN 25 ISO	29.70	33.70	44.00	22	114080251	114080253
DN 32 ISO	38.40	42.40	50.00	25	114080321	114080323
DN 40 ISO	44.30	48.30	56.00	26	114080401	114080403
DN 50 ISO	56.30	60.30	68.50	28	114080501	114080503
DN 65 ISO	72.10	76.10	86.00	32	114080651	114080653
DN 80 ISO	84.30	88.30	100.00	37	114080801	114080803
DN 100 ISO	109.7	114.3	121.00	44	114081001	114081003
DN 125 ISO	134.5	139.7	150.00	34	114081251	114081253
DN 150 ISO	163.1	168.3	176.00	37	114081501	114081503

Walspunftstuk / Walzkegelstutzen

DIN 11851

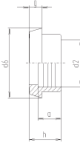

DN	A	D2	D6	G	H	Art. Nr.	
						304	316L
DN 10	12	12.20	22.50	6	17	106000101	106000103
DN 15	12	18.20	28.50	6	17	106000151	106000153
DN 20	12	22.20	36.50	8	18	106000201	106000203
DN 25	15	28.20	44.00	10	22	106000251	106000253
DN 32	18	34.20	50.00	10	25	106000321	106000323
DN 40	20	40.20	56.00	10	26	106000401	106000403
DN 50	22	52.20	68.50	11	28	106000501	106000503
DN 65	25	70.30	86.00	12	32	106000651	106000653
DN 80	28	85.30	100.00	12	37	106000801	106000803
DN 100	35	104.3	121.00	15	44	106001001	106001003

Inch/Zoll

Inch/Zoll	A	D2	D6	G	H	Art. Nr.	
						304	316L
1.00"	15	25.60	44.00	10	22	106011001	106011003
1.50"	20	38.30	56.00	10	26	106011121	106011123
2.00"	22	51.00	68.50	11	28	106012001	106012003
2.50"	25	63.80	86.50	12	32	106012121	106012123
3.00"	25	76.40	93.00	12	32	106013001	106013003
4.00"	35	101.9	121.00	15	44	106014001	106014003
1.25"	15	32.00	50.00	10	22	106011141	106011143