

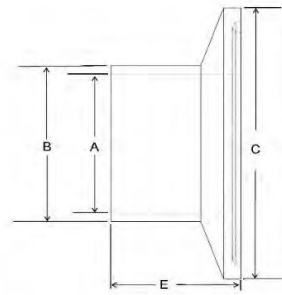

MULDER
STAINLESS

FOOD • PHARMA • PIPE-CLIPS



Ferrule DIN 32676 -A-KK

Art. No	DN	A	B	C	E	316L
184000063	DN 06	06.00	08.00	25.00	12.70	€ 7,45
184000083	DN 08	08.00	10.00	25.00	12.70	€ 7,45
184000103	DN 10	10.00	13.00	34.00	18.00	€ 3,55
184000153	DN 15	16.00	19.00	34.00	18.00	€ 3,65
184000203	DN 20	20.00	23.00	34.00	18.00	€ 3,75
184000253	DN 25	26.00	29.00	50.50	21.50	€ 3,80
184000323	DN 32	32.00	35.00	50.50	21.50	€ 3,85
184000403	DN 40	38.00	41.00	50.50	21.50	€ 4,20
184000503	DN 50	50.00	53.00	64.00	21.50	€ 4,75
184000653	DN 65	66.00	70.00	91.00	28.00	€ 8,50
184000803	DN 80	81.00	85.00	106.0	28.00	€ 9,90
184001003	DN 100	100.0	104.0	119.0	28.00	€ 12,50
184001253	DN 125	125.0	129.0	155.0	28.00	€ 24,50
184001503	DN 150	150.0	154.0	183.0	28.00	€ 36,50
184002003	DN 200	200.0	204.0	233.5	28.00	€ 52,50
184002503	DN 250	250.0	254.0	268.0	28.00	€ 69,50
184003003	DN 300	300.0	304.0	319.0	28.00	€ 99,50
184095003	DN 125 / 5.00"	125.0	129.0	144.4	28.00	€ 24,75
184096003	DN 150 / 6.00"	150.0	154.0	167.0	28.00	€ 36,75
184098003	DN 200 / 8.00"	200.0	204.0	217.4	28.00	€ 52,75

Ferrule DIN 32676 -A-KL LANG

Art. No	DN	A	B	C	E	316L
.184000103028	DN 10	10.00	13.00	34.00	28.60	€ 6,65
.184000153028	DN 15	16.00	19.00	34.00	28.60	€ 6,65
.184000203028	DN 20	20.00	23.00	34.00	28.60	€ 6,55
.184000253036	DN 25	26.00	29.00	50.50	36.00	€ 7,85
.184000323036	DN 32	32.00	35.00	50.50	36.00	€ 8,35
.184000403036	DN 40	38.00	41.00	50.50	36.00	€ 8,45
.184000503036	DN 50	50.00	53.00	64.00	36.00	€ 9,85
.184000653048	DN 65	66.00	70.00	91.00	48.00	€ 24,30
.184000803048	DN 80	81.00	85.00	106.0	48.00	€ 49,50
.184001003048	DN 100	100.0	104.0	119.0	48.00	€ 53,95
.184001253066	DN 125	125.0	129.0	155.0	66.00	€ 66,80
.184001503066	DN 150	150.0	154.0	183.0	66.00	€ 78,50
.184002003066	DN 200	200.0	204.0	233.5	66.00	€ 99,90