

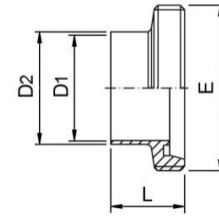

Lasdraadstuk / Gewindestutzen / Male parts



DIN 11851

| DN | D1 | D2 | E | L | Art. Nr. | |
|--------|-------|-------|-------------|----|-----------|-----------|
| | | | | | 304 | 316L |
| DN 10 | 10.0 | 13.00 | Rd 28x1/8" | 21 | 113000101 | 113000103 |
| DN 15 | 16.0 | 19.00 | Rd 34x1/8" | 21 | 113000151 | 113000153 |
| DN 20 | 20.0 | 23.00 | Rd 44x1/6" | 24 | 113000201 | 113000203 |
| DN 25 | 26.0 | 29.00 | Rd 52x1/6" | 29 | 113000251 | 113000253 |
| DN 32 | 32.0 | 35.00 | Rd 58x1/6" | 32 | 113000321 | 113000323 |
| DN 40 | 38.0 | 41.00 | Rd 65x1/6" | 33 | 113000401 | 113000403 |
| DN 50 | 50.0 | 53.00 | Rd 78x1/6" | 35 | 113000501 | 113000503 |
| DN 65 | 66.0 | 70.00 | Rd 95x1/6" | 40 | 113000651 | 113000653 |
| DN 80 | 81.0 | 85.00 | Rd 110x1/4" | 45 | 113000801 | 113000803 |
| DN 100 | 100.0 | 104.0 | Rd 130x1/4" | 54 | 113001001 | 113001003 |
| DN 125 | 125.0 | 129.0 | Rd 160x1/4" | 46 | 113001251 | 113001253 |
| DN 150 | 150.0 | 154.0 | Rd 190x1/4" | 50 | 113001501 | 113001503 |
| DN 200 | 200.0 | 204.0 | Rd 240x1/4" | 50 | 113002001 | 113002003 |

Inch/Zoll

| | | | | | Art. Nr. | |
|-------|------|-------|------------|----|-----------|-----------|
| | | | | | 304 | 316L |
| 1.00" | 22.1 | 25.4 | Rd 52x1/6" | 29 | 113011001 | 113011003 |
| 1.50" | 34.8 | 38.1 | Rd 65x1/6" | 33 | 113011121 | 113011123 |
| 2.00" | 47.5 | 50.8 | Rd 78x1/6" | 35 | 113012001 | 113012003 |
| 2.50" | 60.2 | 63.5 | Rd 95x1/6" | 40 | 113012121 | 113012123 |
| 3.00" | 72.9 | 76.1 | Rd104x1/6" | 40 | 113013001 | 113013003 |
| 4.00" | 97.4 | 101.6 | Rd130x1/4" | 54 | 113014001 | 113014003 |
| 1.25" | 28.8 | 31.80 | Rd 58x1/6" | 32 | 113011141 | 113011143 |

Iso

| DN ISO | | | | | Art. Nr. | |
|------------|-------|-------|-------------|----|-----------|-----------|
| | | | | | 304 | 316L |
| DN 10 ISO | 14.2 | 17.2 | Rd 28x1/8" | 21 | 113080101 | 113080103 |
| DN 15 ISO | 18.1 | 21.3 | Rd 34x1/8" | 21 | 113080151 | 113080153 |
| DN 20 ISO | 23.7 | 26.9 | Rd 44x1/6" | 24 | 113080201 | 113080203 |
| DN 25 ISO | 29.7 | 33.7 | Rd 52x1/6" | 29 | 113080251 | 113080253 |
| DN 32 ISO | 38.4 | 42.4 | Rd 58x1/6" | 32 | 113080321 | 113080323 |
| DN 40 ISO | 44.3 | 48.3 | Rd 65x1/6" | 33 | 113080401 | 113080403 |
| DN 50 ISO | 56.3 | 60.3 | Rd 78x1/6" | 35 | 113080501 | 113080503 |
| DN 65 ISO | 72.1 | 76.1 | Rd 95x1/6" | 40 | 113080651 | 113080653 |
| DN 80 ISO | 84.3 | 88.9 | Rd 110x1/4" | 45 | 113080801 | 113080803 |
| DN 100 ISO | 109.7 | 114.3 | Rd 130x1/4" | 54 | 113081001 | 113081003 |
| DN 125 ISO | 134.5 | 139.7 | Rd 160x1/4" | 46 | 113081251 | 113081253 |
| DN 150 ISO | 168.3 | 163.1 | Rd 190x1/4" | 50 | 113081501 | 113081503 |